

CONSENT
 08/15/08
 CONSENT & PLAN

GENERAL PLAN
 CONSISTING OF SHEETS 1 TO 31
 OF PORTIONS 1 TO 98 OF ERF 2364
 IN THE TOWNSHIP
 NYLSTROOM EXTENSION 11
 NORTHERN PROVINCE

DIAGRAM S.G. No. 1107/2003 DEED OF TRANSFER No.

Completed in September and October 1998,
 and April to August 2002 by me

Blakely
 J. BLAKELY, S.S. 1997
 PROFESSIONAL LAND SURVEYOR

BEACON DESCRIPTIONS:
 A C E F H J K L from bearing
 5M BNC Centre of Mensate Over
 5M BNC 10m Iron Peg
 All other beacons
 unless otherwise indicated

NOTE: All other are 5.00 metres
 unless otherwise indicated.

SERIALS NOTE:
 The figures 91, 92, 93, 94, 95, 96, 97, 98 represents
 a servitude in the Diagram S.G. No. 1107/2003
 and affects portions 96, 98, 99 and 97.

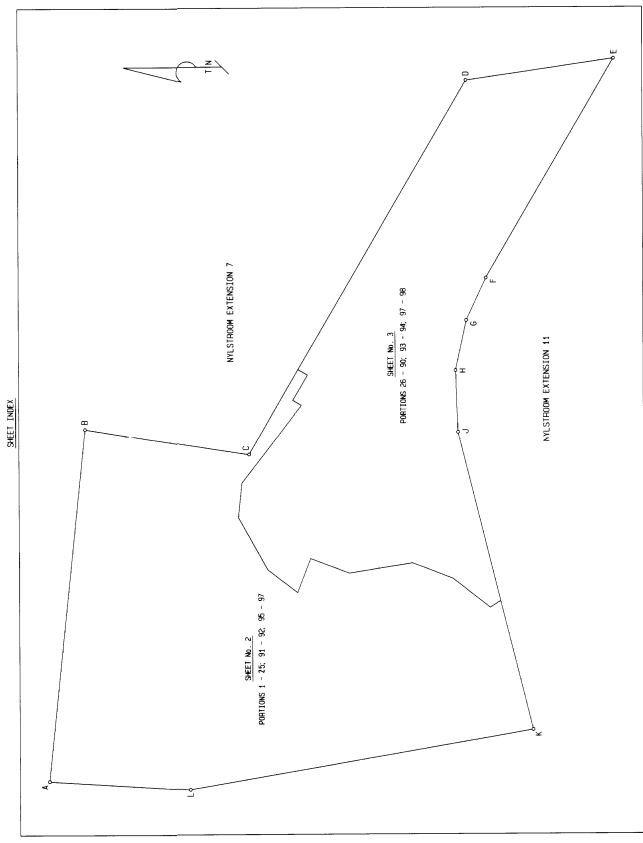

LPI TOKER 0004

Portion	AREAS	Metres
1	1940	1940
2	1417	1417
3	1225	1225
4	1336	1336
5	1356	1356
6	1374	1374
7	2015	2015
8	1460	1460
9	1390	1390
10	1460	1460
11	1390	1390
12	1460	1460
13	1390	1390
14	1460	1460
15	1390	1390
16	1460	1460
17	1390	1390
18	1460	1460
19	1390	1390
20	1460	1460
21	1390	1390
22	1460	1460
23	1390	1390
24	1460	1460
25	1390	1390
26	1460	1460
27	1390	1390
28	1460	1460
29	1390	1390
30	1460	1460
31	1390	1390
32	1460	1460
33	1390	1390
34	1460	1460
35	1390	1390
36	1460	1460
37	1390	1390
38	1460	1460
39	1390	1390
40	1460	1460
41	1390	1390
42	1460	1460
43	1390	1390
44	1460	1460
45	1390	1390
46	1460	1460
47	1390	1390
48	1460	1460
49	1390	1390
50	1460	1460
51	1390	1390
52	1460	1460
53	1390	1390
54	1460	1460
55	1390	1390
56	1460	1460
57	1390	1390
58	1460	1460
59	1390	1390
60	1460	1460
61	1390	1390
62	1460	1460
63	1390	1390
64	1460	1460
65	1390	1390
66	1460	1460
67	1390	1390
68	1460	1460
69	1390	1390
70	1460	1460
71	1390	1390
72	1460	1460
73	1390	1390
74	1460	1460
75	1390	1390
76	1460	1460
77	1390	1390
78	1460	1460
79	1390	1390
80	1460	1460
81	1390	1390
82	1460	1460
83	1390	1390
84	1460	1460
85	1390	1390
86	1460	1460
87	1390	1390
88	1460	1460
89	1390	1390
90	1460	1460
91	1390	1390
92	1460	1460
93	1390	1390
94	1460	1460
95	1390	1390
96	1460	1460
97	1390	1390
98	1460	1460
99	1390	1390

DATA		COORDINATES	
SIDES	MEASURES	SYSTEM	W. 207
	OF		IN
AB	104.50	TRIGONOMETRICAL BEACONS	33 401.02
BC	278.37	TRIGONOMETRICAL BEACONS	33 406.97
CD	181.51	TRIGONOMETRICAL BEACONS	33 412.92
DE	304.95	TRIGONOMETRICAL BEACONS	33 418.87
EF	511.09	TRIGONOMETRICAL BEACONS	33 424.82
FG	71.49	TRIGONOMETRICAL BEACONS	33 430.77
GH	102.15	TRIGONOMETRICAL BEACONS	33 436.72
HI	143.09	TRIGONOMETRICAL BEACONS	33 442.67
IJ	184.03	TRIGONOMETRICAL BEACONS	33 448.62
JK	224.97	TRIGONOMETRICAL BEACONS	33 454.57
KL	265.91	TRIGONOMETRICAL BEACONS	33 460.52
LA	306.85	TRIGONOMETRICAL BEACONS	33 466.47
AL	347.80	TRIGONOMETRICAL BEACONS	33 472.42
BL	388.74	TRIGONOMETRICAL BEACONS	33 478.37
CL	429.68	TRIGONOMETRICAL BEACONS	33 484.32
DL	470.62	TRIGONOMETRICAL BEACONS	33 490.27
EL	511.56	TRIGONOMETRICAL BEACONS	33 496.22
FL	552.50	TRIGONOMETRICAL BEACONS	33 502.17
GL	593.44	TRIGONOMETRICAL BEACONS	33 508.12
HL	634.38	TRIGONOMETRICAL BEACONS	33 514.07
IL	675.32	TRIGONOMETRICAL BEACONS	33 520.02
JL	716.26	TRIGONOMETRICAL BEACONS	33 525.97
KL	757.20	TRIGONOMETRICAL BEACONS	33 531.92
AL	798.14	TRIGONOMETRICAL BEACONS	33 537.87
BL	839.08	TRIGONOMETRICAL BEACONS	33 543.82
CL	880.02	TRIGONOMETRICAL BEACONS	33 549.77
DL	920.96	TRIGONOMETRICAL BEACONS	33 555.72
EL	961.90	TRIGONOMETRICAL BEACONS	33 561.67
FL	1002.84	TRIGONOMETRICAL BEACONS	33 567.62
GL	1043.78	TRIGONOMETRICAL BEACONS	33 573.57
HL	1084.72	TRIGONOMETRICAL BEACONS	33 579.52
IL	1125.66	TRIGONOMETRICAL BEACONS	33 585.47
JL	1166.60	TRIGONOMETRICAL BEACONS	33 591.42
KL	1207.54	TRIGONOMETRICAL BEACONS	33 597.37
AL	1248.48	TRIGONOMETRICAL BEACONS	33 603.32
BL	1289.42	TRIGONOMETRICAL BEACONS	33 609.27
CL	1330.36	TRIGONOMETRICAL BEACONS	33 615.22
DL	1371.30	TRIGONOMETRICAL BEACONS	33 621.17
EL	1412.24	TRIGONOMETRICAL BEACONS	33 627.12
FL	1453.18	TRIGONOMETRICAL BEACONS	33 633.07
GL	1494.12	TRIGONOMETRICAL BEACONS	33 639.02
HL	1535.06	TRIGONOMETRICAL BEACONS	33 644.97
IL	1576.00	TRIGONOMETRICAL BEACONS	33 650.92
JL	1616.94	TRIGONOMETRICAL BEACONS	33 656.87
KL	1657.88	TRIGONOMETRICAL BEACONS	33 662.82
AL	1698.82	TRIGONOMETRICAL BEACONS	33 668.77
BL	1739.76	TRIGONOMETRICAL BEACONS	33 674.72
CL	1780.70	TRIGONOMETRICAL BEACONS	33 680.67
DL	1821.64	TRIGONOMETRICAL BEACONS	33 686.62
EL	1862.58	TRIGONOMETRICAL BEACONS	33 692.57
FL	1903.52	TRIGONOMETRICAL BEACONS	33 698.52
GL	1944.46	TRIGONOMETRICAL BEACONS	33 704.47
HL	1985.40	TRIGONOMETRICAL BEACONS	33 710.42
IL	2026.34	TRIGONOMETRICAL BEACONS	33 716.37
JL	2067.28	TRIGONOMETRICAL BEACONS	33 722.32
KL	2108.22	TRIGONOMETRICAL BEACONS	33 728.27
AL	2149.16	TRIGONOMETRICAL BEACONS	33 734.22
BL	2190.10	TRIGONOMETRICAL BEACONS	33 740.17
CL	2231.04	TRIGONOMETRICAL BEACONS	33 746.12
DL	2271.98	TRIGONOMETRICAL BEACONS	33 752.07
EL	2312.92	TRIGONOMETRICAL BEACONS	33 758.02
FL	2353.86	TRIGONOMETRICAL BEACONS	33 763.97
GL	2394.80	TRIGONOMETRICAL BEACONS	33 769.92
HL	2435.74	TRIGONOMETRICAL BEACONS	33 775.87
IL	2476.68	TRIGONOMETRICAL BEACONS	33 781.82
JL	2517.62	TRIGONOMETRICAL BEACONS	33 787.77
KL	2558.56	TRIGONOMETRICAL BEACONS	33 793.72
AL	2599.50	TRIGONOMETRICAL BEACONS	33 799.67
BL	2640.44	TRIGONOMETRICAL BEACONS	33 805.62
CL	2681.38	TRIGONOMETRICAL BEACONS	33 811.57
DL	2722.32	TRIGONOMETRICAL BEACONS	33 817.52
EL	2763.26	TRIGONOMETRICAL BEACONS	33 823.47
FL	2804.20	TRIGONOMETRICAL BEACONS	33 829.42
GL	2845.14	TRIGONOMETRICAL BEACONS	33 835.37
HL	2886.08	TRIGONOMETRICAL BEACONS	33 841.32
IL	2927.02	TRIGONOMETRICAL BEACONS	33 847.27
JL	2967.96	TRIGONOMETRICAL BEACONS	33 853.22
KL	3008.90	TRIGONOMETRICAL BEACONS	33 859.17
AL	3049.84	TRIGONOMETRICAL BEACONS	33 865.12
BL	3090.78	TRIGONOMETRICAL BEACONS	33 871.07
CL	3131.72	TRIGONOMETRICAL BEACONS	33 877.02
DL	3172.66	TRIGONOMETRICAL BEACONS	33 882.97
EL	3213.60	TRIGONOMETRICAL BEACONS	33 888.92
FL	3254.54	TRIGONOMETRICAL BEACONS	33 894.87
GL	3295.48	TRIGONOMETRICAL BEACONS	33 900.82
HL	3336.42	TRIGONOMETRICAL BEACONS	33 906.77
IL	3377.36	TRIGONOMETRICAL BEACONS	33 912.72
JL	3418.30	TRIGONOMETRICAL BEACONS	33 918.67
KL	3459.24	TRIGONOMETRICAL BEACONS	33 924.62
AL	3500.18	TRIGONOMETRICAL BEACONS	33 930.57
BL	3541.12	TRIGONOMETRICAL BEACONS	33 936.52
CL	3582.06	TRIGONOMETRICAL BEACONS	33 942.47
DL	3623.00	TRIGONOMETRICAL BEACONS	33 948.42
EL	3663.94	TRIGONOMETRICAL BEACONS	33 954.37
FL	3704.88	TRIGONOMETRICAL BEACONS	33 960.32
GL	3745.82	TRIGONOMETRICAL BEACONS	33 966.27
HL	3786.76	TRIGONOMETRICAL BEACONS	33 972.22
IL	3827.70	TRIGONOMETRICAL BEACONS	33 978.17
JL	3868.64	TRIGONOMETRICAL BEACONS	33 984.12
KL	3909.58	TRIGONOMETRICAL BEACONS	33 990.07
AL	3950.52	TRIGONOMETRICAL BEACONS	33 996.02
BL	3991.46	TRIGONOMETRICAL BEACONS	34 001.97
CL	4032.40	TRIGONOMETRICAL BEACONS	34 007.92
DL	4073.34	TRIGONOMETRICAL BEACONS	34 013.87
EL	4114.28	TRIGONOMETRICAL BEACONS	34 019.82
FL	4155.22	TRIGONOMETRICAL BEACONS	34 025.77
GL	4196.16	TRIGONOMETRICAL BEACONS	34 031.72
HL	4237.10	TRIGONOMETRICAL BEACONS	34 037.67
IL	4278.04	TRIGONOMETRICAL BEACONS	34 043.62
JL	4318.98	TRIGONOMETRICAL BEACONS	34 049.57
KL	4359.92	TRIGONOMETRICAL BEACONS	34 055.52
AL	4400.86	TRIGONOMETRICAL BEACONS	34 061.47
BL	4441.80	TRIGONOMETRICAL BEACONS	34 067.42
CL	4482.74	TRIGONOMETRICAL BEACONS	34 073.37
DL	4523.68	TRIGONOMETRICAL BEACONS	34 079.32
EL	4564.62	TRIGONOMETRICAL BEACONS	34 085.27
FL	4605.56	TRIGONOMETRICAL BEACONS	34 091.22
GL	4646.50	TRIGONOMETRICAL BEACONS	34 097.17
HL	4687.44	TRIGONOMETRICAL BEACONS	34 103.12
IL	4728.38	TRIGONOMETRICAL BEACONS	34 109.07
JL	4769.32	TRIGONOMETRICAL BEACONS	34 115.02
KL	4810.26	TRIGONOMETRICAL BEACONS	34 120.97
AL	4851.20	TRIGONOMETRICAL BEACONS	34 126.92
BL	4892.14	TRIGONOMETRICAL BEACONS	34 132.87
CL	4933.08	TRIGONOMETRICAL BEACONS	34 138.82
DL	4974.02	TRIGONOMETRICAL BEACONS	34 144.77
EL	5014.96	TRIGONOMETRICAL BEACONS	34 150.72
FL	5055.90	TRIGONOMETRICAL BEACONS	34 156.67
GL	5096.84	TRIGONOMETRICAL BEACONS	34 162.62
HL	5137.78	TRIGONOMETRICAL BEACONS	34 168.57
IL	5178.72	TRIGONOMETRICAL BEACONS	34 174.52
JL	5219.66	TRIGONOMETRICAL BEACONS	34 180.47
KL	5260.60	TRIGONOMETRICAL BEACONS	34 186.42
AL	5301.54	TRIGONOMETRICAL BEACONS	34 192.37
BL	5342.48	TRIGONOMETRICAL BEACONS	34 198.32
CL	5383.42	TRIGONOMETRICAL BEACONS	34 204.27
DL	5424.36	TRIGONOMETRICAL BEACONS	34 210.22
EL	5465.30	TRIGONOMETRICAL BEACONS	34 216.17
FL	5506.24	TRIGONOMETRICAL BEACONS	34 222.12
GL	5547.18	TRIGONOMETRICAL BEACONS	34 228.07
HL	5588.12	TRIGONOMETRICAL BEACONS	34 234.02
IL	5629.06	TRIGONOMETRICAL BEACONS	34 240.07
JL	5670.00	TRIGONOMETRICAL BEACONS	34 246.02
KL	5710.94	TRIGONOMETRICAL BEACONS	34 251.97
AL	5751.88	TRIGONOMETRICAL BEACONS	34 257.92
BL			